

Detail what vehicles will come on to the event site and why they are required	Type of vehicle	Number of vehicles	Purpose	Times on-site

Please indicate on your site map where the vehicles will travel

Event application

Please complete the following checklist relating to your upcoming event. To have your event evaluated page 4 lists additional document required to be submitted along with this application.

	Requirement	Yes/No		Compliance, permits and permissions that may be required for approval
Venue	1. Are you installing fencing or temporary barriers? If yes, please list type (for example, star pickets, free standing) and size	Yes	No	
	2. Do you wish to access the venue's electrical outlets? Please list each piece of electrical equipment you will use and their amperage requirements?	Yes	No	All electrical leads are to be tagged and tested in accordance with WorkSafe requirements prior to use.
	3. Do you wish to access water outlets from the venue? If yes, list what you will use the water for?	Yes	No	
	4. Do you require ground preparation or other assistance from the council? a. Lawn mowing b. Irrigation marking c. Power line marking d. Other (please specify): _____	Yes Yes Yes Yes	No No No No	<i>For other, the council will provide quote if required</i>
Traffic and parking	5. Will the event require any road or street closure?	Yes	No	If yes, you will be required to provide a traffic management plan that is developed by a qualified traffic management company. You will also be required to apply for a Temporary Road Closure permit from the council. Approval and/or permit from Victoria Police may be required, along with VicRoads and other emergency services.
	6. Will there be an increase in road congestion in the area?	Yes	No	
	7. Will there be restricted access to, or require the use of footpaths or public car parks?	Yes	No	
	8. Will there be parking beyond the immediate event site?	Yes	No	

	9. Will you be erecting any roadside signage? You should ensure that your public liability insurance covers signage.	Yes	No	Local Laws permit from the council must be obtained.
	10. Are you providing disabled parking at your event?	Yes	No	
Temporary structures	11. Will your event be held in a place >500m ² to which admission is charged	Yes	No	A place of public entertainment permit from the council may be required.
	12. Will your event have: a. Seating stands for more than 20 persons?	Yes	No	
	b. Tent or marquees with a floor area more than 100m ²	Yes	No	
	c. Stage exceeding 150m ² in floor area?	Yes	No	
13. Will your event have: a. Mechanical rides? b. Jumping castle or other inflatables? c. Animal nursery or pony rides (hand washing facilities MUST be accessible by the nurse exit/post rides)	Yes Yes Yes	No No No	If yes to any, you must provide a copy of the Certificate of Currency (Public Liability insurance) with a minimum of \$20 million of the external contractor to the council. The device must meet current Australian Standards.	
Public health and safety	14. Will food or beverages be sold or served at the event (for example, sausage sizzle)	Yes	No	Under the <i>Victorian Food Act</i> , all food vendors must register on Streatrader (streatrader.health.vic.gov) a minimum 14 days prior to the event.
	15. Will you be using existing bins at the venue for your event?	Yes	No	
	16. Do you require additional bins for your event? If yes, \$20 per set (general waste and recycle) for a maximum of 10 sets can be supplied by the council.	Yes	No	Should you have greater waste needs, please contact Cleanaway Transpacific on (02) 6024 4590.
	17. Do you wish to access public toilets at the venue?	Yes	No	
	18. Do you require the public toilets to be cleaned: a. Before b. During (additional charges may apply) c. After your event (additional charges may apply)	Yes Yes Yes	No No No	
	19. Will you use portable toilet facilities?	Yes	No	
	20. Will there be fireworks, firecrackers or pyrotechnics?	Yes	No	You will be required to apply to WorkSafe and CFA for a permit to conduct fireworks. Please ensure you provide a copy of the permits to the council along with a Local Law permit.
21. Will there be amplified noise, such as speakers or broadcast equipment.	Yes	No	A local law permit is required for amplified noise	
Alcohol	22. Will alcohol be consumed?	Yes	No	A Local Law permit is required from alcohol consumed in a park from sunset to sunrise.
	23. Will alcohol be sold or served?	Yes	No	A Liquor License from the Victorian Commission for Gambling and Liquor Regulation is required. A copy of the liquor license must be provided to the council prior to your event/activity, as well as a plan to prevent under age alcohol consumption.

If you answered yes to any of the above questions, a member of the the council's civic services team will be in touch soon. *PLEASE NOTE: Wodonga Council requires ten (10) working days to process any permit so please ensure you complete this paperwork as promptly as possible.*

Public notification	Describe how you intend to notify local residents, businesses, participants and spectators about your proposed event?
	Is there anything else you would like to tell the council about your event/activity?

Event application checklist/attachments

	Yes	No	N/A
Certificate of Currency for Public Liability Insurance (minimum \$10 million cover). You must ensure your insurance covers your event or activity.			
Site Plan is required if you have answered 'yes' to the following questions: 1, 9, 12 and 19			
Risk Management Plan is required if you have answered 'yes' to the following questions: 5, 12, 13, 20, 21 and 22			
Traffic Management Plan			
Liquor licence			
Permits from other authorities			

Applicant's declaration and agreement

I am authorised to lodge this application seeking approval to host an event within the city of Wodonga. I acknowledge that the information contained in this form is true and correct and that the event will fully comply with the conditions of the event approval and other conditions as required by Wodonga Council. I have read the terms and conditions. I have read and understand the council's *Event Management Planning Guide*. (wodonga.vic.gov.au)

Contact name: _____

Signature of applicant: _____ Date: _____

Enquiries: Events team at Wodonga Council (02) 6022 9300 or info@wodonga.vic.gov.au

Deliver to: Events,
104 Hovell St,
Wodonga,
VIC 3690

OR

Post to: Events,
Wodonga Council,
PO Box 923,
Wodonga,
VIC 3689

Fax to: (02) 6022 9322

OFFICE USE ONLY		
Date:		
Public Liability Insurance	Own	The council
Permit required:		
Booking Number:		

Hire of parks and reserves terms and conditions

Bookings

Complete and return this parks and reserves booking form within 14 calendar days. Confirmation of booking will be acknowledged via a signed approval letter and bookings should not be considered confirmed until this letter is received.

PLEASE NOTE: This is a public park/reserve and does not entitle the user to exclusive use of the facility (including barbecue facilities).

All roadways surrounding the park/reserve should be left clear at all times.

Council officers have the right to refuse, request changes or terminate a booking for inappropriate use of asset. Hirers may be required to provide full details of entertainment on request.

Trees located on the park/reserve are not to be used for securing any items or signage

All equipment and decorations provided by the hirer must be removed from the site post event.

Subletting of park/reserve is not permitted without the council's written consent.

No pegs or spikes allowed in ground (to hold down structures/marquees), without the council's written consent*. The council can provide information on irrigation lines.

Vehicles are not allowed in parks/reserves without the council's written consent.

Smoking is prohibited within 10 metres of outdoor public children's playground equipment, skate parks and sporting venues during organised underage sporting events.

The council may cancel bookings at short notice due to inclement weather or ground conditions.

For bookings that can involve large numbers of participants, significant structures, and/or OH&S risks, further application process, conditions and requests may apply.

The user must be at the reserve at all times during the booking period and must provide a proper number of competent attendants and supervisors to ensure the efficient supervision and safety of people within the reserve and associated facilities.

The council reserves the right to expel person/s or terminate the function due to any breach or condition of hire and/or misconduct by patrons.

The council reserves the right to request external security for higher-risk functions at a cost to the hirer.

The council's access/limit of use

Authorised council officers are entitled to access all parks/reserves regardless of bookings.

The user must comply with all local laws, liquor licence regulations, *Environmental Protection Act*, *Health Act* or any regulations for the care, protection and management of the facility used.

Damage

The user will take steps to ensure activity or event patrons will not cause damage or defacement to reserves or site

equipment. Failure to adhere to the above will result in charges to restore the facility to an appropriate condition.

Indemnity

The user agrees to indemnify and keep indemnified Wodonga Council, its servants and agents and each of them from and against all actions, costs, claims, charges, expenses, penalties, demands and damages whatsoever which may be brought or made or claimed against them or any of them arising from the user's performance or purported performance of its obligations under this user agreement and be directly related to the negligent acts, errors or omission of the user.

The user's liability to indemnify Wodonga City Council shall be reduced proportionally to the extent that any act or omission of Wodonga Council, its servants or agents, contributed to the loss of liability.

Insurance

Public liability insurance will be required for all organised commercial, community and private activities on council land.

PLEASE NOTE: Short-term insurance cover may be available to purchase through the council. Please contact the council to discuss such cover.

Keys

Keys are required for some council parks and reserves, barbecue areas, lights and areas requiring power.

Keys are issued from the council's office and are to be returned to the office on the first working day after the event.

Litter

You are to remove any rubbish and ensure the park is in a neat and tidy condition at the completion of use.

If the council needs to remove any rubbish left behind, you will be charged accordingly, and an invoice issued for payment.

Dispute Resolution:

If a dispute or difference between the parties arises in connection with the Contract, then either party may deliver by hand a written notice of dispute identifying and providing details of the dispute. Within 10 Business Days of the giving of a notice of dispute, the parties shall together confer at least once to attempt to resolve the dispute or to agree on resolving the dispute by other means. If the dispute has not been resolved within 20 Business Days of the giving of a notice of dispute, that dispute shall be referred to arbitration. Arbitration shall be effected by an arbitrator nominated by the Chairperson of the Chapter of The Institute of Arbitrators and Mediators Australia (Victorian Chapter). Arbitration shall be conducted in accordance with the Rules of the Institute of Arbitrators and Mediators Australia for the Conduct of Commercial Arbitrations.

* For smaller marquees, the council prefers weighting the legs to secure the marquee.

Junction Square event guidelines

General

- Junction Square is a bookable space for both public and private events.
- Users of Junction Square need to be mindful of the existing businesses on site and ensure that patron access is not impeded or business operations interrupted.
- As a courtesy, event organisers are required to inform all businesses operating at Junction Square and The Promenade precinct of their upcoming event.

Guidelines for retail car/motorbike displays

Junction Square can be booked for retail car and motorbike displays/car and motorbike launches as long as the following guidelines are met:

- Commercial car and motorbike retailers are able to display new model vehicles (released in Australia) for no more than three consecutive days at a time.
- No more than five vehicles can be used at any launch.
- Commercial car and motorbike retailing businesses are able to book Junction Square no more than twice within a 12 month period.
- Vehicles are only allowed to be displayed on the paved area marked on the accompanying site plan in red, known as the 'Heavy Vehicle Access Area'.
- Council does not accept any liability for damage to vehicles and/or the hirer's property.
- Signage and branding is to be negotiated with Wodonga Council's event team contact prior to the display taking place.
- Other permits may need to be obtained and paid for prior to any event taking place. This will be determined by council's local laws team once a booking application is lodged.
- Council reserves the right to refuse any booking.

Vehicle access

- Vehicular access to Junction Square is via Church St only.
- Under no circumstances are vehicles to drive over the rectangular in-ground strip lights, embedded in the paved area. Vehicles **must** straddle the strip lights when accessing and exiting the site. Failure to do so may cause damage to the lights with any repair costs being the responsibility of the event organiser.
- Vehicles are not permitted to undertake tight U-turns on the paved surface, at the risk of dislodging paving stones and/or leaving tyre marks on the paving. Event organisers will be liable for any costs associated with site rectification.
- Vehicles are able to unload in the area on the site map marked as the 'Pedestrian Area' under the gantries, but must not remain on site during an event.
- Vehicles are permitted to remain on site in the area marked 'Heavy Vehicle Access Zone' during an event.
- The load limit for vehicle access to the site is **three tonnes**.

Church St closure

- It is possible to close Church St between Bond St and Elgin Boulevard for larger events. Event organisers need to apply to Wodonga Council for a 'Road Closure Permit' and provide an authorised traffic management plan, which needs to be approved by Wodonga Council officers.

Gantries and gantry wires

- Nothing is to be attached or hung from the easternmost gantry. This is one of the original gantries and the engineering specifications do not match those of the five new gantries.
- Nothing is to hang or be attached to the metal wires connecting the gantries.
- Event organisers must obtain permission prior to hanging or attaching anything to the overhead gantries and metal supports. This includes signage and advertising banners.

Northern and southern faces of the gantries

- An allowance has been made for the installation of a 9.25-metre wide (width between frames) by two-metre deep sign between each frame (four frames).
- This is the maximum single sign size permissible per bay. A number of individual signs may be installed but their combined area must not exceed 18.5 square metres.
- All signs are to be secured to the column frames only.

Eastern and western ends of the gantries

- An allowance has been made for the installation of an 11-metre wide (width between columns) by two-metre deep signs at each end of the structure.
- This is the maximum single sign size permissible at either end of the structure. A number of individual signs may be installed but their combined area must not exceed 22 square metres.
- All signs are to be secured to the column frames only.
- Alternative loading situations can be assessed on a case-by-case basis.

Scissor lifts

- Scissor lifts are permitted on the paved areas but they must have pneumatic tyres and weigh less than two tonnes (2000kg).

Use of the grass area

- Marquees are permitted on the grass area but only weights are to be used to keep the structure in place. No pegs are allowed.
- All details of the marquee's dimensions, construction, anchoring, bump in/bump out need to form part of the booking application process, prior to any approval being given.
- Event organisers are responsible for any damage they cause to the grass area and costs to rectify any damage will be incurred.

Permits

- Council permits may need to be obtained prior to an event being held at Junction Square. This will be determined by the council's local laws officers once event application forms have been reviewed.

Electricity

- It is the responsibility of event organisers that all electrical leads used on site are tagged and tested.
- In the case of any after-hours issue with electricity on the site, event organisers need to phone the City of Wodonga's after hours emergency number (02) 6022 9300 and follow the prompts.

Food and cooking

- Event organisers must ensure that vendors who are cooking, preparing food and barbequing provide some form of protection from oil spills and general stains on the paving.
- Mobile coffee vans must provide paving protection from coffee spills and coffee grounds stains.
- Event organisers will be responsible to pay for any cleaning costs associated with their event.

Rubbish and cleaning

- Event organisers expecting numbers of more than 500 people must provide additional rubbish bins on site at their own cost.
- Event organisers expecting numbers of more than 1000 people must provide porta loos at their own cost.
- Extra cleaning costs may be incurred for events utilising the public toilets on the platform area, where extra cleans are required over and above the normal cleaning regime. Event organisers will be required to engage and pay the council's contract cleaner directly in this situation.

Heavy vehicle access only permitted in area bounded red.
 All other paved areas accessible to vehicles under 3 tonnes.
 All vehicles must avoid driving on Inground Strip Lights.

Legend

- 1 1x15amp GPO
- 2 4x15amp GPO
- 3 1x32amp 3 Phase
- W 6x15amp GPO
- 1x32amp 3 Phase
- Water Point
- S Sewer Point
- B Bin (Waste and Recycle)
- Water Bubbler
- Inground Strip Light (no drive)
- Seating

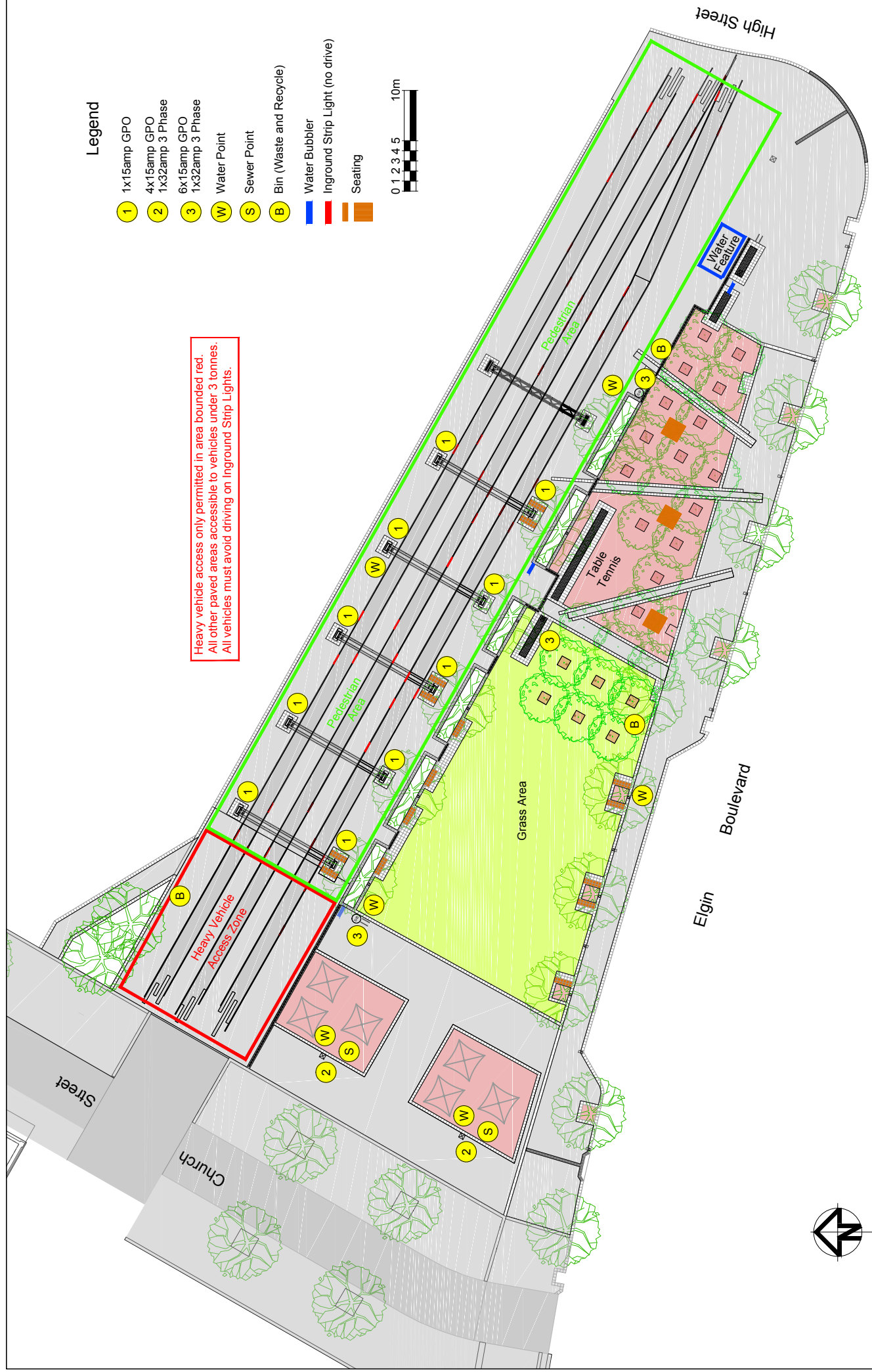

Junction Square - Services Location Plan

